



Augent™ OPG550 Optical Plasma Vacuum Gauge

The INFICON Augent™ Optical Plasma Gauge is a compact and intelligent solution for vacuum monitoring. Augent™ combines two sensor technologies into one compact device for gas type monitoring from 1×10^{-7} to 5 mbar and to measure total pressure from 1×10^{-7} mbar to atmosphere at the same time. Augent™ is protected by an integrated Pirani sensor to switch off plasma above 20 mbar. The fast optical measurement principle allows the detection of in principle any type of gas.

ADVANTAGES

- High speed leak detection allows chamber leak test
- Increase of productivity and yield
- Long life time, no filament burns, air inrush protection
- Withstand process chemistry
- Smart algorithm for easy integration
- Compact design and small footprint
- Reliable and fast start up

ORDER INFORMATION

Type	OPG550
OPG550 TI,LC,9DSub,16CF-R	3OF0-013-010P
OPG550 TI,LC,9DSub,16KF	3OF0-011-010P
OPG550 TI,LC,9DSub,25KF	3OF1-016-010P
OPG550 TI,LC,9DSub,40CF-F	3OF1-01Q-010P
OPG550 TI,LC,9DSub,40KF	3OF1-017-010P
OPG550 TI,LC,9DSub,8-VCR f	3OF0-01E-010P

ORDER INFORMATION

3 0 F 0 - 0 0 1 - 0 1 0 P

Flange

- 1 DN 16 ISO-KF
- 3 DN 16 CF-R
- 6 DN 25 ISO-KF
- E 8 VCR female

SPECIFICATIONS

Type		OPG550
Measurement system		Cold Cathode according inverted magnetron principle and Thermal conductivity according Pirani principle
Measurement range N ₂	mbar	1×10 ⁻⁷ ... 5
Measurement range N ₂	Torr	(7.6×10 ⁻⁸ ... 3.8)
Detection limit 25 liter chamber		
O ₂ leaks in pressure rise method	mTorr/min	≥0.3
O ₂ leaks during pump down from atmosphere with N ₂ backfill	mTorr/min	≥1
Accuracy total pressure reading N ₂		
1 x 10 ⁻⁷ ... 100 mbar	% of reading	30
100 ... 1000 mbar	% of reading	50
Repeatability total pressure reading N ₂		
1 x 10 ⁻⁷ ... 100 mbar	% of reading	5
Pressure		
Limited to inert gases < 50°C	bar (absolute)	≤10
Temperature		
Operation (ambient)	°C	+5 ... +50
Storage	°C	-20 ... +70
Bakeout at flange with electronic unit	°C	≤80
Bakeout at flange w/o electronic unit	°C	≤120
Relative humidity for 30 days a year		
Humidity	%	≤95 (non-condensing)
Supply voltage		
At gauge	V (dc)	+14.5 ... +30
Supply voltage		
Ripple	V (p-p)	≤1
Supply voltage		

SPECIFICATIONS

Type		OPG550
Power consumption	W	≤5
Supply voltage		
Fuse to be connected	AT	1
Output signal		
Analog	V (dc)	0 ... +10
Output signal		
Digital		RS232C
Electrical connection		D-Sub, 9-pin, male
High voltage (in the measuring chamber)		
Ignition voltage	kV	≤4.5
Operating voltage	kV	≤3.3
Materials exposed to vacuum		
General		Al ₂ O ₃ , Stainless steel 1.4435
Anode		Molybdenum
Ionization chamber		Titanium, stainless steel 1.4016
Ignition aid		Stainless steel 1.4310
Vacuum flange		
		½ in. tube (spiral baffle): DN16 ISO-KF, DN16 CF-R, 8-VCR female
		1 in. tube (standard baffle): DN25 ISO-KF, DN40 ISO-KF, DN40 CF-F
Internal volume	cm ³ (in. ³)	≤ 46 (2.81)
Weight	g	≤700
Dimensions		
Footprint	mm	68 x 68
Height	mm	≤ 154
Protection type		IP40
Standards		CE

SPAREPARTS

	OPG550
OPG550 spare sensor, 16-CF-R	351-591
OPG550 spare sensor, 16-KF	351-590
OPG550 spare sensor, 25-KF	351-592
OPG550 spare sensor, 8-VCR female	351-593

ACCESSORIES

	OPG550
Centering ring DN 16 ISO-KF, Inox / FPM	211-066
Centering ring DN 25 ISO-KF, SS/FPM	211-068
Clamping ring DN 10-16 ISO-KF	211-001
Clamping ring DN 20-25 ISO-KF	211-002
Copper seal DN 16 CF; set of 10 pcs	213-451
Diagnostic cable 1.9m (P3)	303-333
Power Supply, OPG550, RS232/Analog Out	351-051

DIMENSIONS

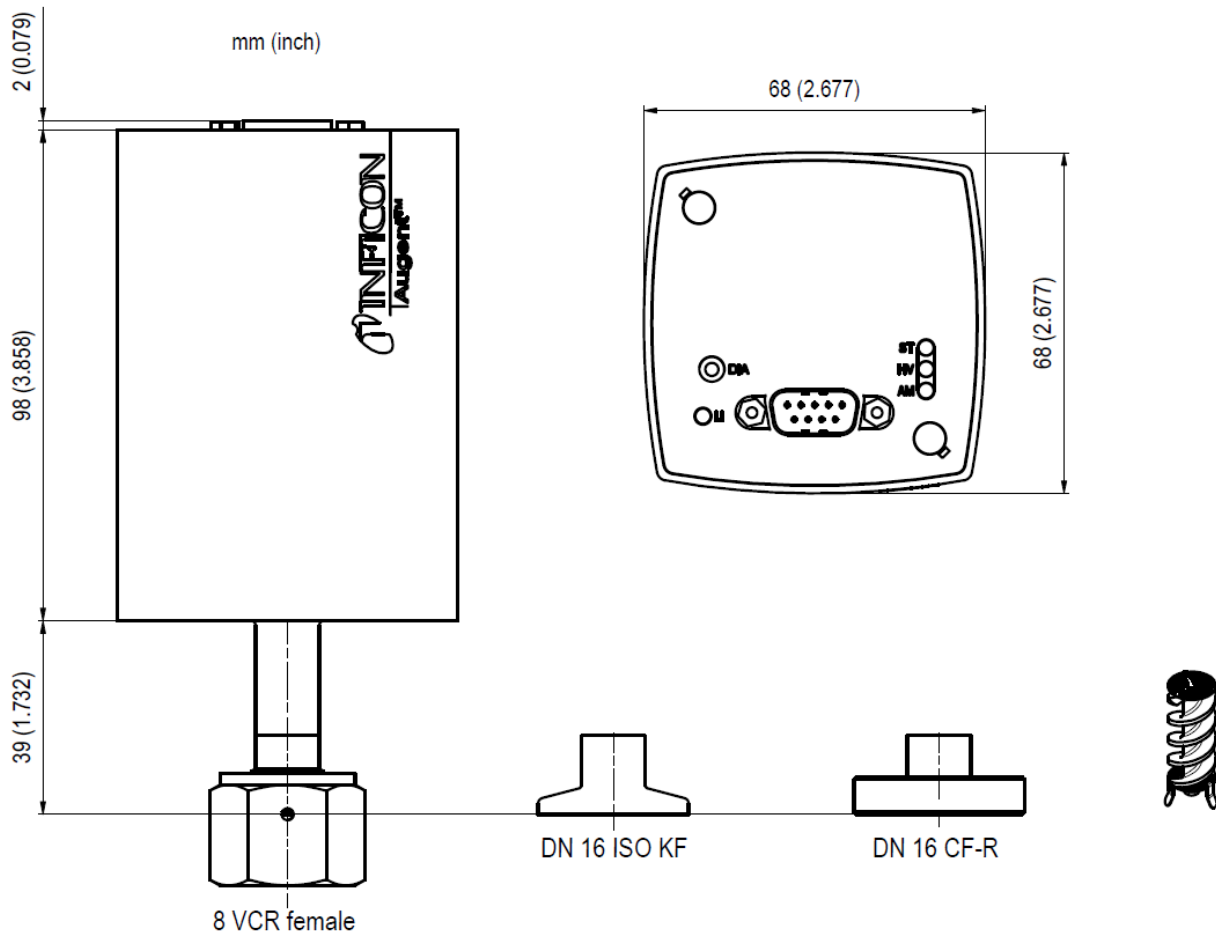

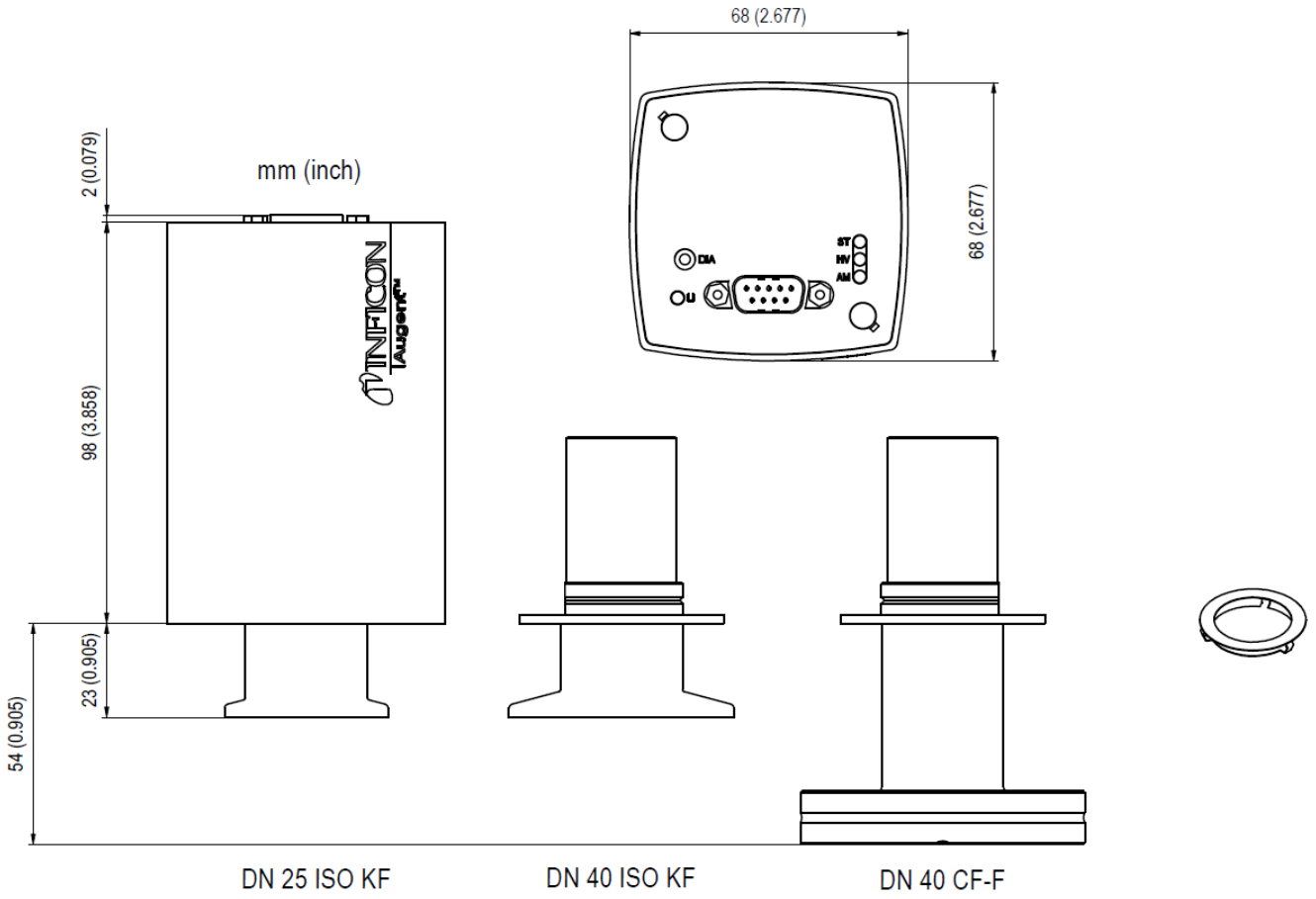

www.inficon.com reachus@inficon.com

Due to our continuing program of product improvements, specifications are subject to change without notice. RateWatcher is a trademark of INFICON. All other trademarks are the property of their respective owners.

Version vom (2022-05) © 2022 INFICON

09. auf den
10.03.2021;
Hochauflösen
es Bild
eingestellt n